

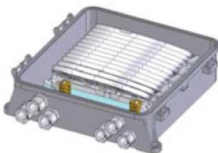

24/96 Fibre Distribution Box

- ✓ 2 entry cables PG 13,5 for cables 9 ÷ 12,5 mm,
- ✓ 2 exit cables PG 11 for cables 7 ÷ 10,5 mm,
- ✓ 12 splices trays type SC for 24 optical fibres,
- ✓ 8 splices trays type SE for 96 optical fibres,
- ✓ central strength member o aramid yarn clamp,
 - ✓ key locking system (on request),
 - ✓ wall installation.

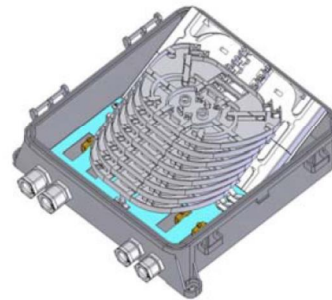
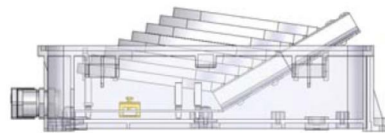
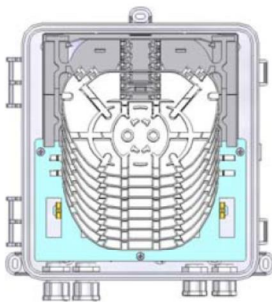
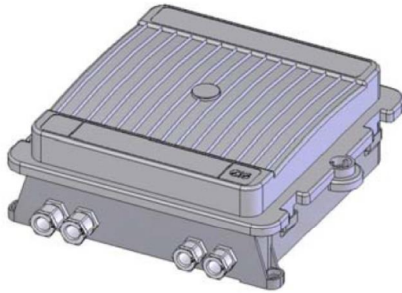

General Description:
The Distribution Box is designed to splicing 24/96 optical fibre. The unit is supplied with 12 single circuit splice trays or 8 single element splice trays.
Characteristics:
IP protection code 56. incoming cable port designed according to the project. Outgoing cable ports designed according to the project.
Out line dimensions:
272 x 270 x 100 mm
Code:

Ordering information:

PN
WC-FDB-24/96F

Description
WAVECOM 24/96F Fibre Distribution Box.